

Mini Machine

User Manual



Creative Concepts, Inc.
1500 Georgia Road
Irondale, Alabama 35210

Phone: 205-838-0570
Fax: 205-838-0999
Toll Free: 866-838-0570

Pucker Powder ®

From the Staff of Creative Concepts:

Thank you for your recent purchase of our **Mini Pucker Powder Machine**. Our company is constantly evolving and working to make our products simpler and more marketable for you our customer. It is your suggestions and recommendations that have molded our business to where it is today. Customer care is critical to our operation and we therefore hope that you will contact us with any comments or concerns. All of us at Creative Concepts look forward to a long and prosperous business relationship with you. Please call our toll free line at 866-838-0570 with any questions or comments.

1. **Storage:** Storage should be in a cool, dry area (55-68 Degrees Fahrenheit at approximately 50% relative humidity).
2. **Do not get candy wet.**
3. **Allergen Statement:** Our current formulas (and processing equipment) for Pucker Powder are free of the main allergens and any derivatives. This allergen list includes peanuts, tree nuts, dairy, egg, wheat, fish, and shellfish. Additionally, the processing and packaging of peanuts and tree nuts are done in a separate room from the other items.

Covered by Patents: US D476,855 S , 6,619,510, Additional Patents Pending.



Index

Section 1.

Table clamp instructions.

Section 2.

Wall mount instructions.

Section 3.

Mechanism parts.

Section 4.

Mini oval cap replacement.

Section 5.

Candy loading instructions.

Section 6.

Replacing the mechanism housing.



Section 1

Table Use Instructions

(also mounted to back of machine):

TABLE CLAMP INSTRUCTIONS

1. Carefully Place Machine on its back

2. Identify:

Rod ←

Large **Notch** (in slot) ←

Slot ←

Pin (in Rod) ←

Patents Pending
Toll Free
(866)-838-0570

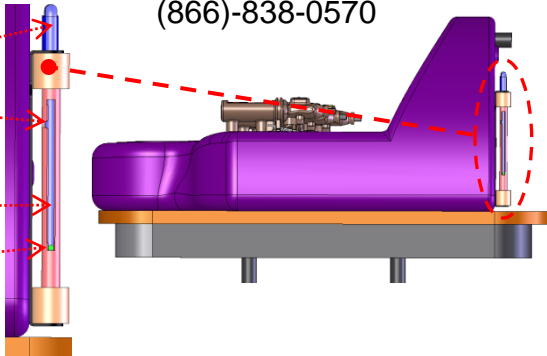

3. Return Machine to Upright position

4. Pull **Rods** out to either position **A** or **B** (depending on table, ie. wood or plastic):

Position A. Wood Top (1" thin)

Pull **Rod** out until **Pin** contacts **End** of **Slot**

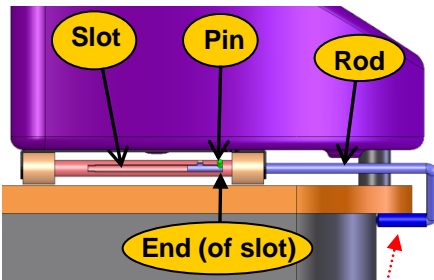

Position B. Plastic Top Table (2"-2 3/8" thick)

Pull **Rod** out until **Pin** can be rotated into **Notch** (Rod will rotate 90 degrees and fit over thick table edge)

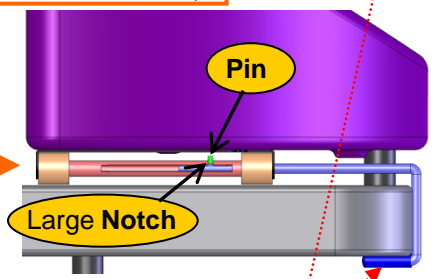

5. Locate Machine on edge of table so that the **Rods** are contacting as shown.



★ Table clamp only comes with table top mini machines

Section 2

Wall Mount Instructions :

STEP 1.

Attach Bracket to wall:

(use a minimum of 3 holes for all types of installation)

1. Wall Stud or Solid Wood Slat Wall (use Screws included)
2. Drywall: using **only** SNAPTOGGLE® Toggle Bolts install wall bracket by following manufacturer's instructions (see page 5)

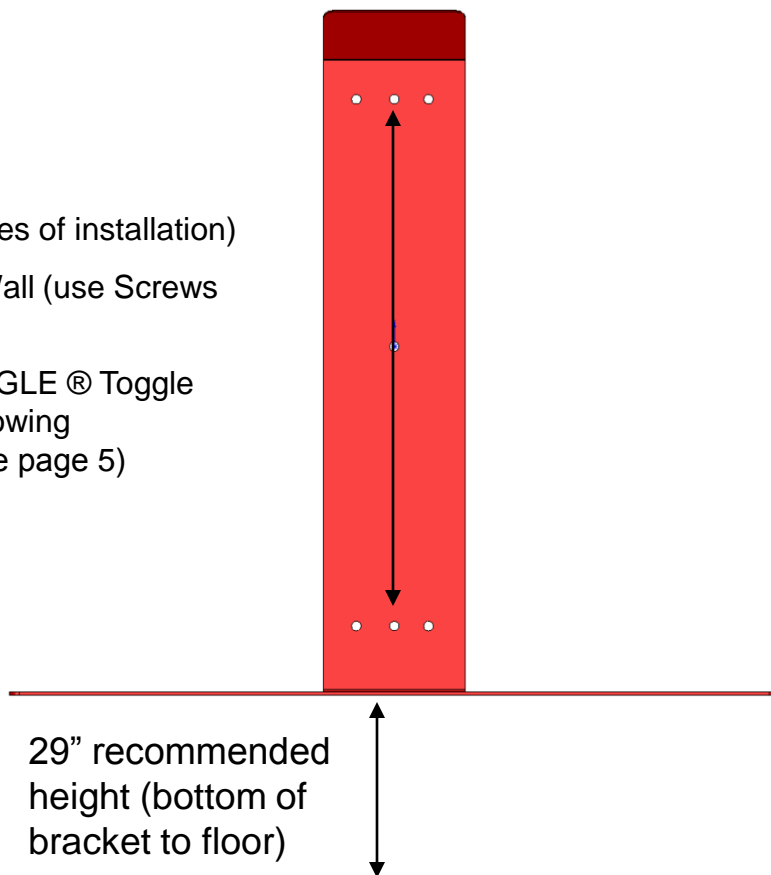

STEP 2.

Attach Machine to Wall Bracket:

1. Place Base on Bracket so that the handle catch is securely underneath the built-in handle on the back of the base
2. Place washers on bolts and then secure bottom of Base with 2 washer/bolt combinations

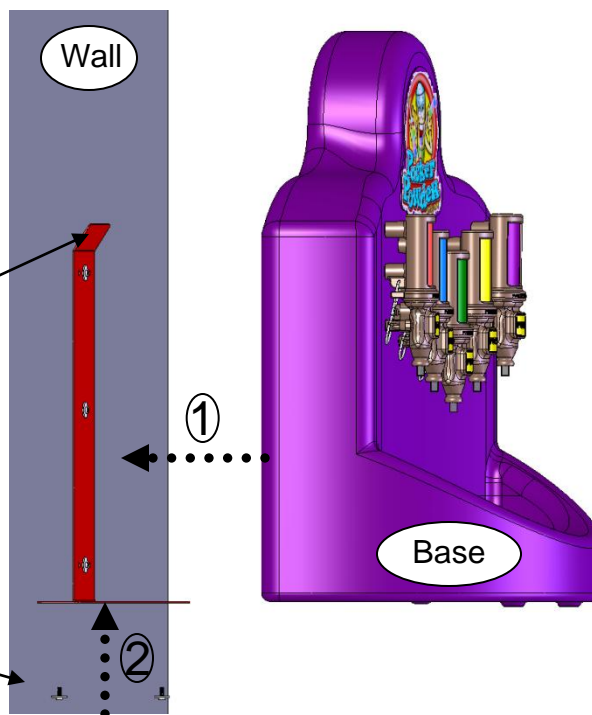

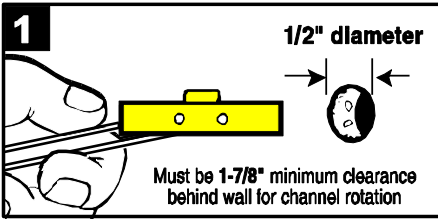
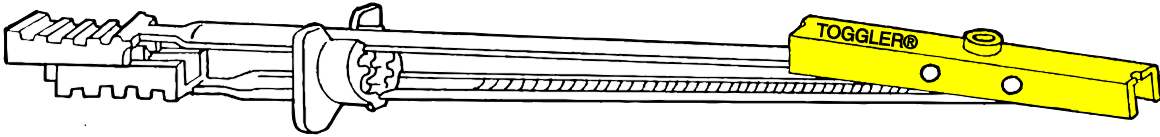

Drill $\frac{1}{2}$ " dia. hole. Grasp handle between two fingers. Make sure cap washer is at a position just before and not on ratcheting section (shown above). Push one section with thumb until metal channel is flat alongside plastic straps and slide channel through hole.

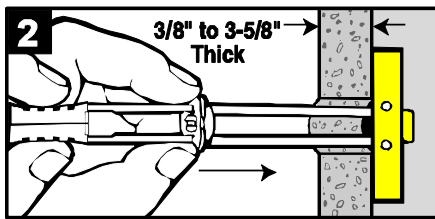

When metal channel has cleared the wall push both parts of handle ends into alignment with each other. Next pull handle gently so metal channel rests flush behind wall as you slide plastic cap along straps with other hand until flange of cap is flush and snug with wall.

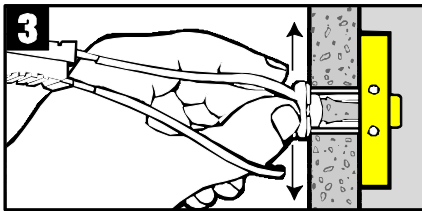

Place thumb between plastic straps. Push side to side snapping off straps flush with cap.

Note: this is the SNAPTOGGLE® manufacturer stock image. The Pucker Powder Mini Wall Bracket will be used between bolt and wall.

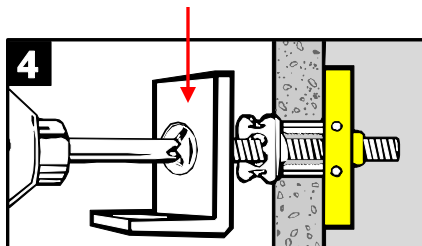

Insert bolt through Pucker Powder Wall Bracket hole and tighten until flush with wall. Minimum clearance behind wall: $1 \frac{7}{8}$ " (minimum of 3 SNAPTOGGLE anchors should be used)

U.S. Patent No. 6,161,999 and foreign counterparts thereof and of 4,650,386. Other patents pending. TOGLER and SNAPTOGGLE are worldwide registered trademarks of MPC.



Section 3

Mechanism Parts:

1. Mini Mech Housing

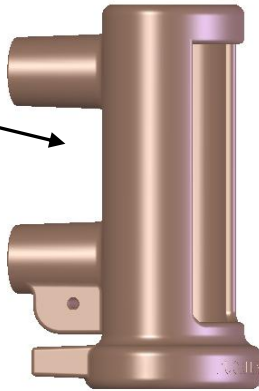

2. Mini Mech Bottom

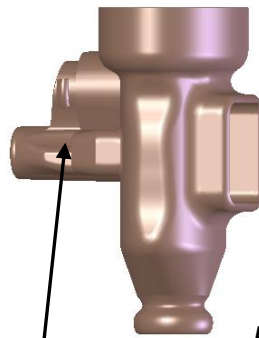

4. Mini Mech Thumb Pinch

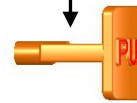

7. Mini Mech Thumb Pinch Bolt



6. Mini Mech Wire Snap

5. Mini Mech Spring



3. Mini Mech Bottom Back (note: 2 small bolts, not shown, hold this part in place)

Mini Mech Bottom Modification (fall 07):

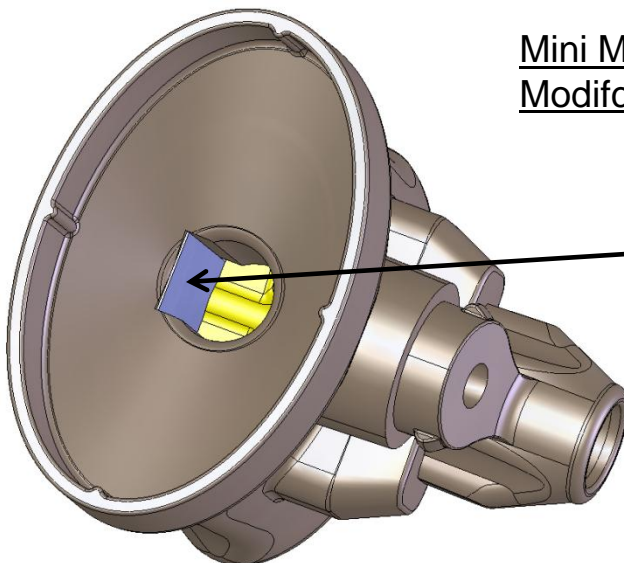

Thumb Pinch Plate



Section 4

Mini oval cap replacement:



Step 1. Remove existing flexible tube away from candy bottom.



Step 2. Insert candy bottle into mini mechanism bottom.



Step 3. Hold candy bottle as shown.



Step 4. Push down and back on the mini mechanism bottom to remove old candy bottle cap.



Step 5. Place a new oval tube cap on the candy bottle.

 Do not throw oval tube caps away



Section 5

Candy Loading Instructions:



Step 1: Push wire toward rear of the machine releasing the mechanism bottom

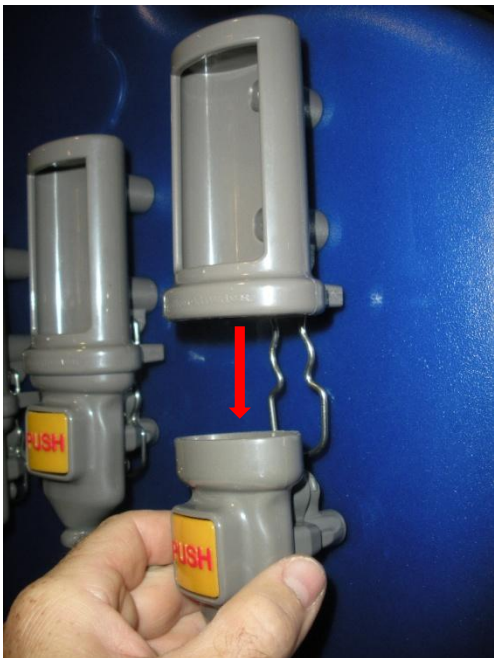

Step 2: Pull down on mechanism bottom, removing it from the machine



Candy Loading Instructions:



Step 3: Depress button on mini mechanism bottom and slide over tube.



Step 4: Make sure that the candy bottle is completely up into the mini mechanism bottom.



Candy Loading Instructions:



Step 5 :Insert mechanism bottom with candy bottle into mechanism housing. Push Mechanism Bottom completely up until it stops. Do not push yellow PUSH button while reattaching.



Step 6 : Making sure that Mechanism Bottom w/Candy bottle is completely up into mechanism housing, reverse step 1 by pulling wire forward until it locks the mechanism bottom into place.

Step 7 : Fill all 4 remaining flavors and then Pucker away!!!



Section 6

Replacing the mechanism housing

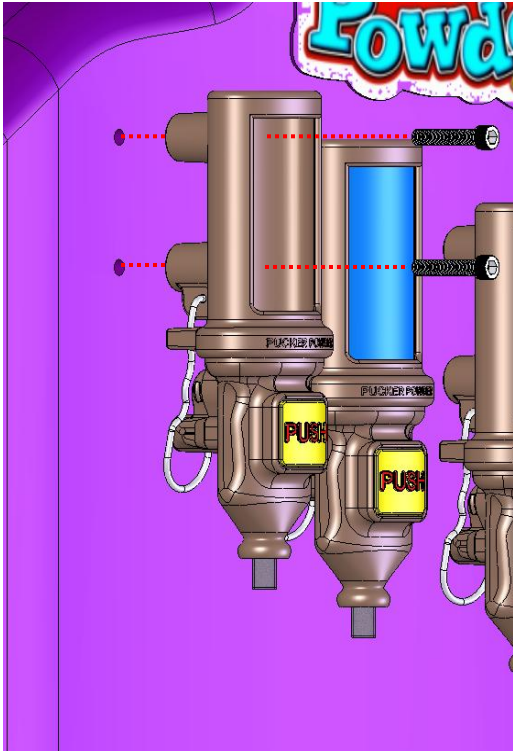

There is no need to remove mech housing unless you are cleaning or replacing this item:

Step 1. Using a 3/16" allen wrench remove the 2 bolts attaching the Mech to the Machine Base

Step 2. When replacing the mech housing insert both bolts slightly into base and then tighten until the mech is flush to the Base

If candy continues to flow when Thumb Pinch is not depressed?

Step 1 : remove Mini Mech Bottom

Step 2 : using a phillips head screw-driver turn the **Mech Thumb Pinch Bolt**> counter-clockwise in ¼ turn increments until the candy stops flowing

Step 3: return Mech Bottom to machine

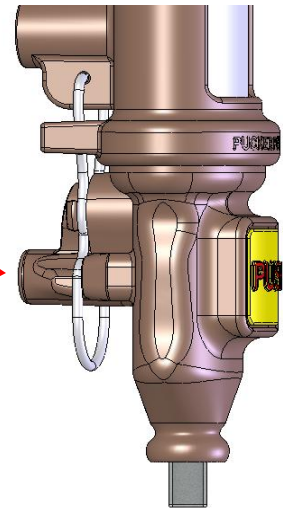

TECH SUPPORT: 866-838-0570 techsupport@puckerpowder.com

www.puckerpowder.com

Creative Concepts 1500 Georgia RD Building A Irondale, Al. 35210

