



12 Flavor Dispensing Unit

User Manual



Creative Concepts, Inc.
1500 Georgia Road
Irondale, Alabama 35210

Phone: 205-838-0570
Fax: 205-838-0999
Toll Free: 866-838-0570

Publication Version. 10.0
12 color FUN 07-24-2012

Pucker Powder ®

From the Staff of Creative Concepts:

Thank you for your recent purchase of our **12 Color Pucker Powder Machine**. Our company is constantly evolving and working to make our products simpler and more marketable for you our customer. It is your suggestions and recommendations that have molded our business to where it is today. Customer care is critical to our operation and we therefore hope that you will contact us with any comments or concerns. All of us at Creative Concepts look forward to a long and prosperous business relationship with you. Please call our toll free line at 866-838-0570 with any questions or comments.

1. **Storage:** Pucker Powder, powdered candies should be stored at 80 degrees Fahrenheit maximum and 70% maximum humidity.

2. **Do not get candy wet.**

3. **Allergen Statement:** All of Pucker Powder's powdered candies current recipes and the processes are free of Major Food Allergens and their derivatives. The Major Food Allergens are dairy, egg, fish, shellfish, tree nuts, peanuts, wheat, and soybeans.

Covered by Patents: US D476,855 S , 8,042,581 Additional Patents Pending.

Index

<u>Part Identification</u>	<u>2</u>
<u>Candy Loading Instructions</u>	<u>3</u>
<u>Cleaning Machine & Mechanism</u>	<u>4</u>
<u>Removing Tube Holder & Waste Bin</u>	<u>5</u>

Part Identification - Complete Unit

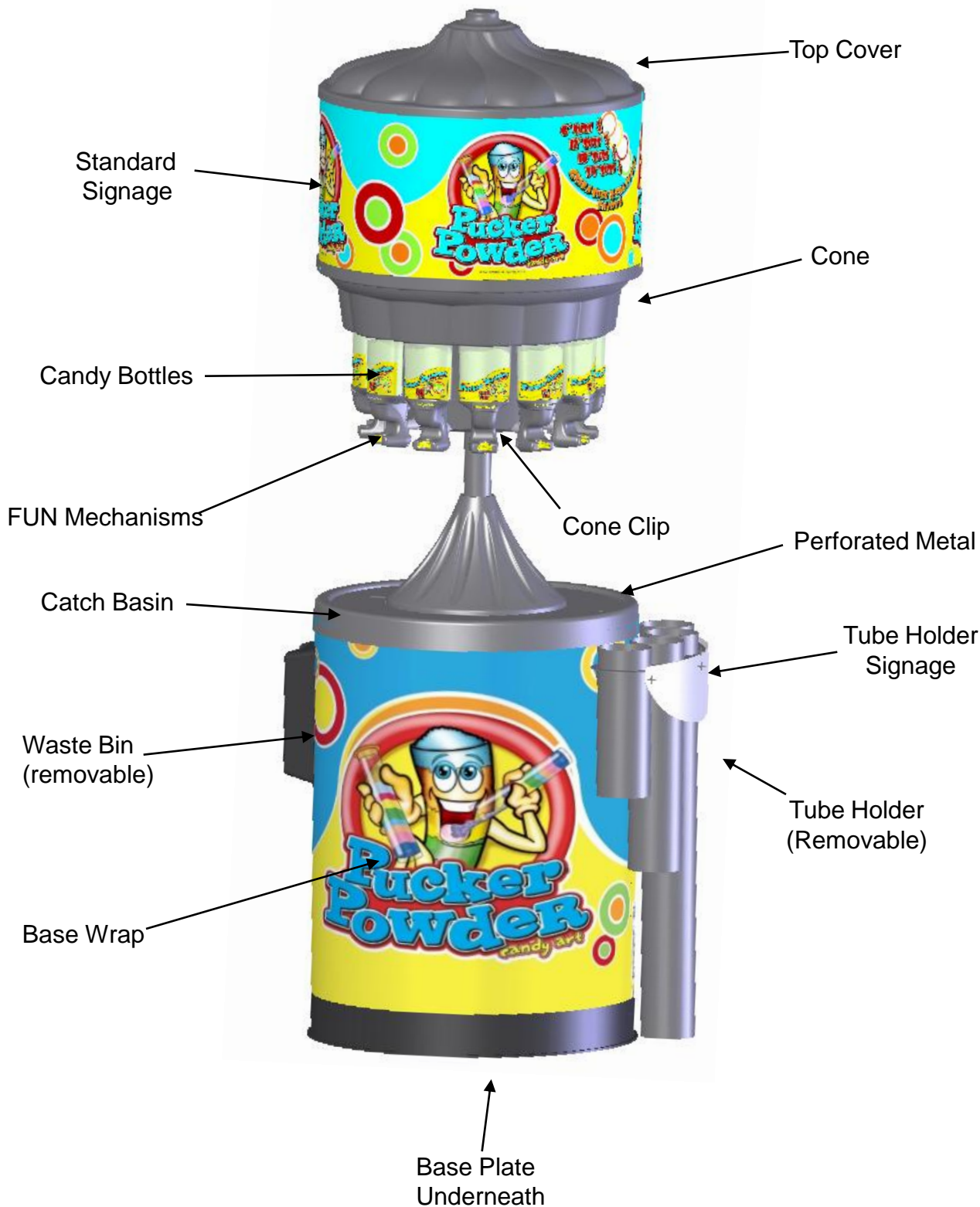

Candy Loading Instructions

1

Remove the "Fun Mech" by loosening the thumbscrew as shown.

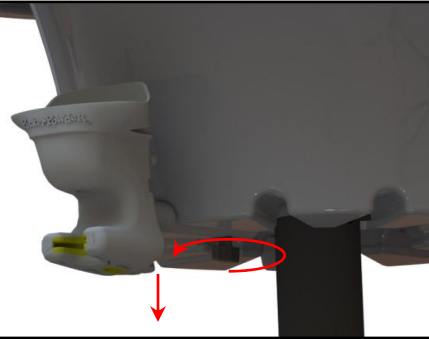

2



Remove the cap and foil seal from the bottle of candy. ***NOTE:*** Keep the cap so that it may be used to seal the bottles when cleaning mechanism. **PRESSING FIRMLY**, insert the bottle into the Fun Mech and rotate them as shown.

3

(1) Place the upper end of the bottle into the pocket of the machine (2) adjust/slide mechanism shaft back and forth until thumbscrew threads into threaded plate (3) tighten the thumbscrew.

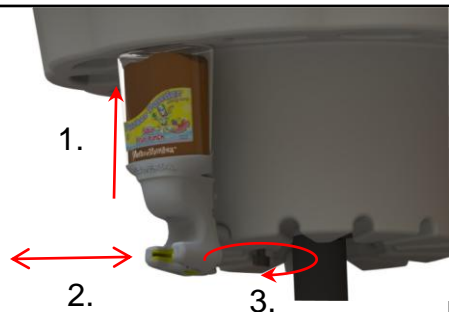

WARNING



****!!! DO NOT OVERTIGHTEN THUMBSCREW !!! **** (Over tightening may result in breaking mechanism shaft and/or stripping threads of thumbscrew)

Cleaning Machine & Mechanism

Cleaning Machine – To keep your 12 Color Wrap looking its best , clean the outside of the machine with a cloth dampened with warm water and mild soap once every two weeks recommended.

Cleaning Fun Mechanism

Option 1. Place the mechanism in any home or commercial dish washing unit. Allow to completely dry before re-assembly. The drying process may take several hours. Shake the Funnel Mechanism briskly to check for any signs of remaining moisture. If moisture is found, allow more time to dry.

Option 2. Wash the mechanism in hot soapy water and rinse thoroughly. The Funnel Mechanism should be shaken briskly in the water to loosen any accumulated candy. Allow to completely dry before re-assembly. The drying process may take several hours. Shake the Funnel Mechanism briskly to check for any signs of remaining moisture. If moisture is found, allow more time to dry.

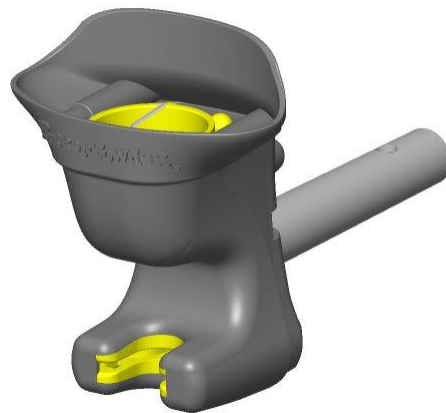

Removing Tube Holder & Waste Bin

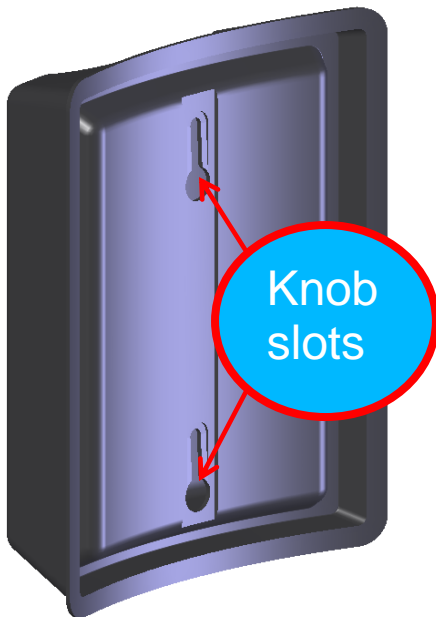
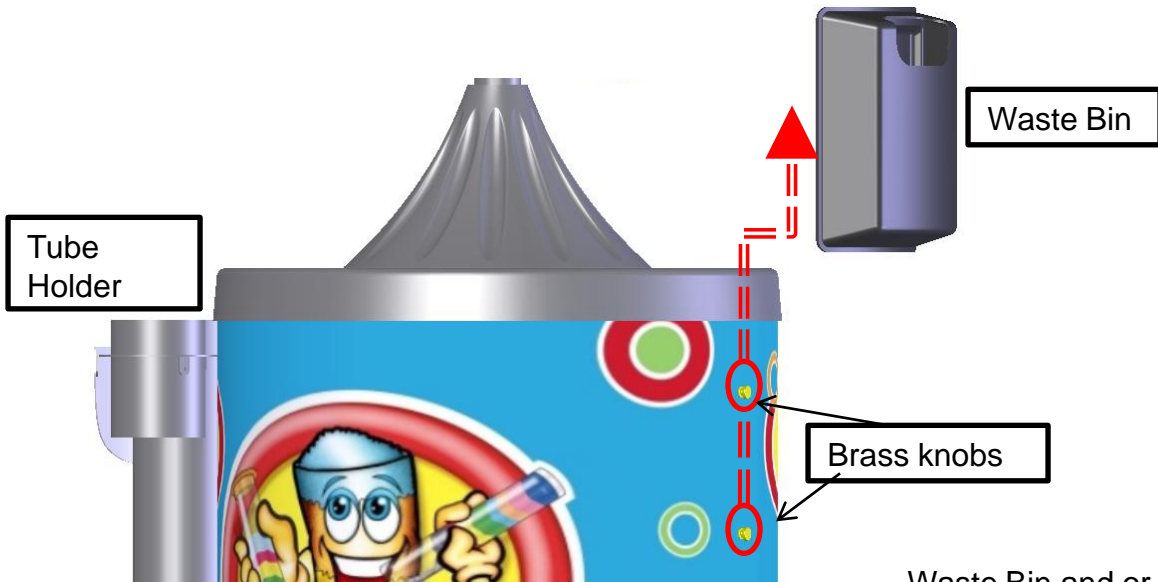

Waste Bin and or Tube Holder can be removed:

1. lift up and off the machine
2. Note Both items are held in place by two brass knobs on either side of the machine
3. Waste Bin and Tube holder have a key slot that slides over brass knobs and locks onto machine
4. Return to machine by reversing step one

**Give us a call with any questions or concerns you may have.
Toll Free 1-866-838-0570**

**We appreciate your business and hope that you and your customers
enjoy our product.**